

# Embedded NVR

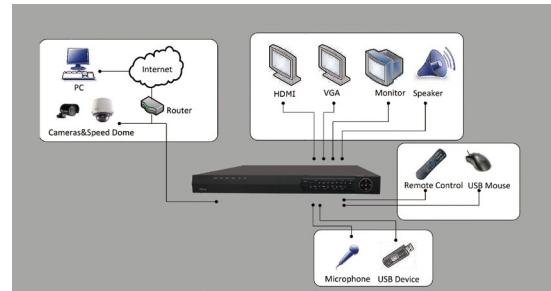

## Key features

- Third-party network cameras supported
- Up to 5 Megapixels resolution recording
- HDMI and VGA output at up to 1920×1080P resolution
- 8/16-ch synchronous playback
- HDD quota and group management

## Rear Panel of HDS-N7600I-ST

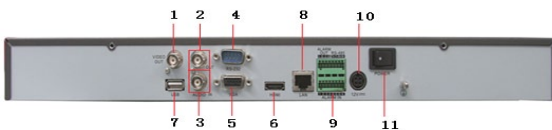

1. Video out
2. Audio out
3. Audio in
4. RS-232
5. VGA interface
6. HDMI interface
7. USB interface
8. LAN
9. RS-485 interface, alarm in, alarm out
10. 12 VDC power supply
11. Switch

## Specifications

|                             | HDS-N7608I-ST   | HDS-N7616I-ST |
|-----------------------------|---|---------------|
| <b>Video / Audio input</b>  |   |               |
| IP video input              | 8-ch  | 16-ch         |
| Audio in                    | 1-ch, BNC (2.0 Vp-p, 1kΩ) (Voice talk input)  |               |
| <b>Video / Audio output</b> |   |               |
| Recording resolution        | 5MP /3MP /1080P /UXGA /720P /VGA /4CIF /DCIF /2CIF /CIF /QCIF   |               |
| CVBS output                 | 1-ch, BNC (1.0 Vp-p, 75 Ω)<br>Resolution: 704 × 576 (PAL); 704 × 480 (NTSC)   |               |
| HDMI output                 | 1-ch, resolution:<br>1920 × 1080P /60Hz, 1920 × 1080P /50Hz, 1600 × 1200 /60Hz, 1280 × 1024 /60Hz, 1280 × 720 /60Hz, 1024 × 768 /60Hz |               |
| VGA output                  | 1-ch, resolution:<br>1920 × 1080P /60Hz, 1600 × 1200 /60Hz, 1280 × 1024 /60Hz, 1280 × 720 /60Hz, 1024 × 768 /60Hz                     |               |
| Audio output                | 1-ch, BNC (Linear, 600Ω)  |               |
| Playback resolution         | 5MP /3MP /1080P /UXGA /720P /VGA /4CIF /DCIF /2CIF /CIF /QCIF   |               |
| Synchronous playback        | 8-ch  | 16-ch         |
| <b>Hard disk</b>            |   |               |
| SATA                        | 2 SATA interfaces   |               |
| Capacity                    | Up to 4TB capacity for each disk  |               |
| <b>External interface</b>   |   |               |
| Network interface           | 1 RJ-45 10 /100 /1000 Mbps self-adaptive Ethernet interface   |               |
| Serial interface            | 1 RS-232 interface (for parameters configuration, maintenance , transparent channel); 1 RS-485 interface (reserved);                  |               |
| USB interface               | 2, USB 2.0  |               |
| Alarm in                    | 4   |               |
| Alarm out                   | 2   |               |
| <b>General</b>              |   |               |
| Power supply                | 12 VDC  |               |
| Consumption                 | ≤ 13 W (without hard disk or DVD-R/W)   |               |
| Working temperature         | -10 °C ~ +55 °C   |               |
| Working humidity            | 10%~90%   |               |
| Chassis                     | 19-inch rack-mounted 1U chassis   |               |
| Dimensions (W x D x H)      | 445 × 261 × 44.5 mm   |               |
| Weight                      | ≤ 4 Kg ( without hard disk or DVD-R/W )   |               |